

III-e | STORMWATER PLANS

Project: BUFFALO Stream, Buffalo, NY, 01519-01-001 (ENG) - Buf.DMA, Alabama, NY, Engineering/Engineering Plans/Stream Project
Date: 2024-01-06 14:06:34
By: mwohlford
Drawing: V:\081591 - Stream NY\081591-01-001 (ENG) - BUFO1A Alabama NY\Engineering/Engineering Plans/Stream Project\BUFFALO\081591-01-001-PRO SURFACE.dwg

Cut/Fill Report

Generated: 2024-01-06 14:06:34
By user: mwohlford
Drawing: V:\081591 - Stream NY\081591-01-001 (ENG) - BUFO1A Alabama NY\Engineering/Engineering Plans/Stream Project\BUFFALO\081591-01-001-PRO SURFACE.dwg

Name	Type	Cut Factor	Fill Factor	2d Area (Sq. Ft.)	Cut (Cu. Yd.)	Fill (Cu. Yd.)	Net (Cu. Yd.)
EARTHWORK	full	1.000	1.000	870776.39	944.51	70411.49	69466.98-Fill>
Totals				2d Area (Sq. Ft.)	Cut (Cu. Yd.)	Fill (Cu. Yd.)	Net (Cu. Yd.)
Total				870776.39	944.51	70411.49	69466.98-Fill>

* Value adjusted by cut or fill factor other than 1.0

SOIL RESTORATION NOTES:

- Soil Restoration must be applied to all proposed pervious areas (i.e. lawn areas) in accordance with 2024 New York State Stormwater Management Design Manual (2024 Design Manual) Section 5.1.6. Soil restoration includes mechanical decompaction and compost amendment.
- During periods of relatively low to moderate subsol moisture, the disturbed subsoils are returned to rough grade and the following Soil Restoration steps are applied:
 - Apply 3 inches of compost over subsoil
 - Till compost into subsoil to a depth of at least 12 inches using a cat-mound ripper, tractor-mounted disc, or tiller, mixing, and circulating air and compost into subsoils.
 - Rock-pile until uplifted stone/rock materials of 4 inch and larger size are cleaned off the site.
 - Apply topsoil to a depth of 6 inches
 - Vegetate as required.
- Tilling (step 2) should not be performed within the drip line of any existing trees or over utility installations that are within 24 inches of the surface.
- Compost shall be aged, from plant derived materials, free of viable weed seeds, have no visible free water or dust produced when handling, pass through a half-inch screen and have a pH suitable to grow desired plants. Compost shall be in accordance with 2024 Design Manual Section 5.3.4.3.2.
- Maintenance of soil restoration areas shall be provided in accordance with 2024 Design Manual Section 5.1.6.

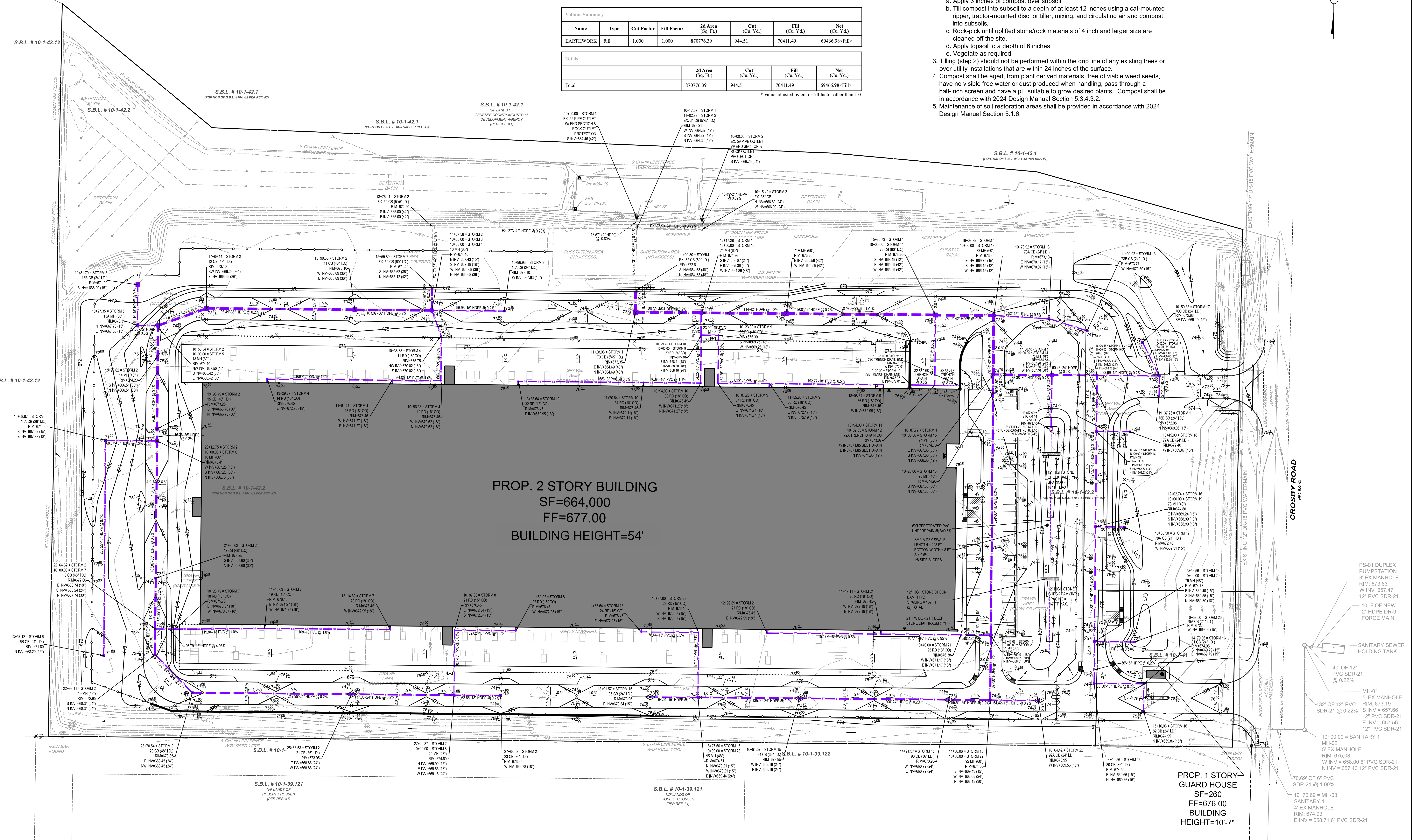
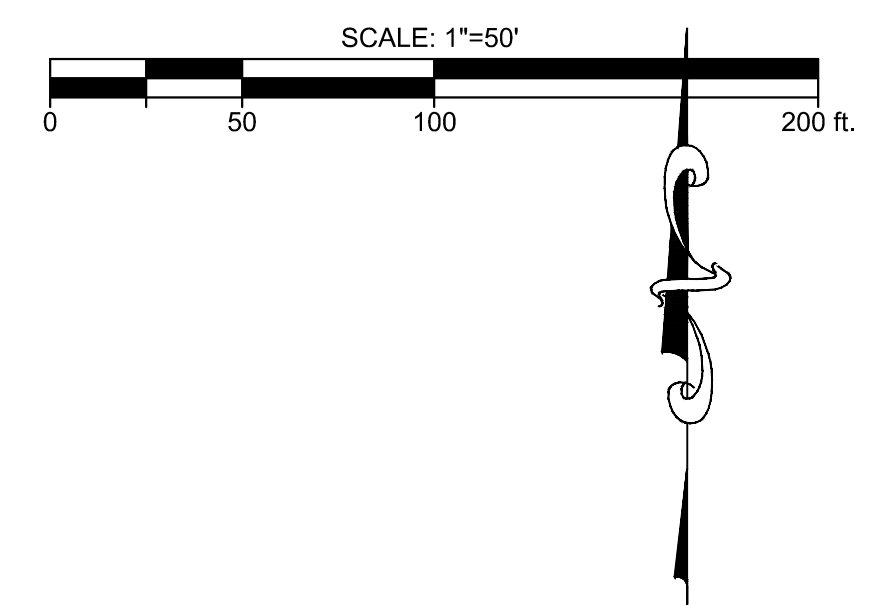

PROP. 2 STORY BUILDING
SF=664,000
FF=677.00
BUILDING HEIGHT=54'

PROP. 1 STORY GUARD HOUSE
SF=260
FF=676.00
BUILDING HEIGHT=10'-7"

DATE	CHD	DATE	CHD	DATE	CHD	DATE	CHD	DATE	CHD
01		02		03		04		05	
06		07		08		09		10	
11		12		13		14		15	
16		17		18		19		20	
21		22		23		24		25	
26		27		28		29		30	
31		32		33		34		35	
36		37		38		39		40	
41		42		43		44		45	
46		47		48		49		50	
51		52		53		54		55	
56		57		58		59		60	
61		62		63		64		65	
66		67		68		69		70	
71		72		73		74		75	
76		77		78		79		80	
81		82		83		84		85	
86		87		88		89		90	
91		92		93		94		95	
96		97		98		99		100	

SOIL RESTORATION NOTES:
DATE: JANUARY 9, 2024
CHD: PDD

Bowman
Bowman Consulting Engineering, Land Surveying & Landscape Architecture
1000 West 10th Street, Suite 302
Buffalo, NY 14202
Phone: 716-835-8400
Fax: 716-835-8405
Email: info@bowmaneng.com
www.bowmaneng.com

ERIC L. KELLER, N.Y. Professional Engineer, No. 085234-1

BUFA - PROJECT DOUBLE REED NORTH AND SOUTH CAMPUS GRADING AND DRAINAGE PLAN - SOUTH CAMPUS
TOWN OF ALABAMA, GENESEE COUNTY, NEW YORK

SHEET No. **C-151-S**

