

**III-g | LANDSCAPE PLAN**

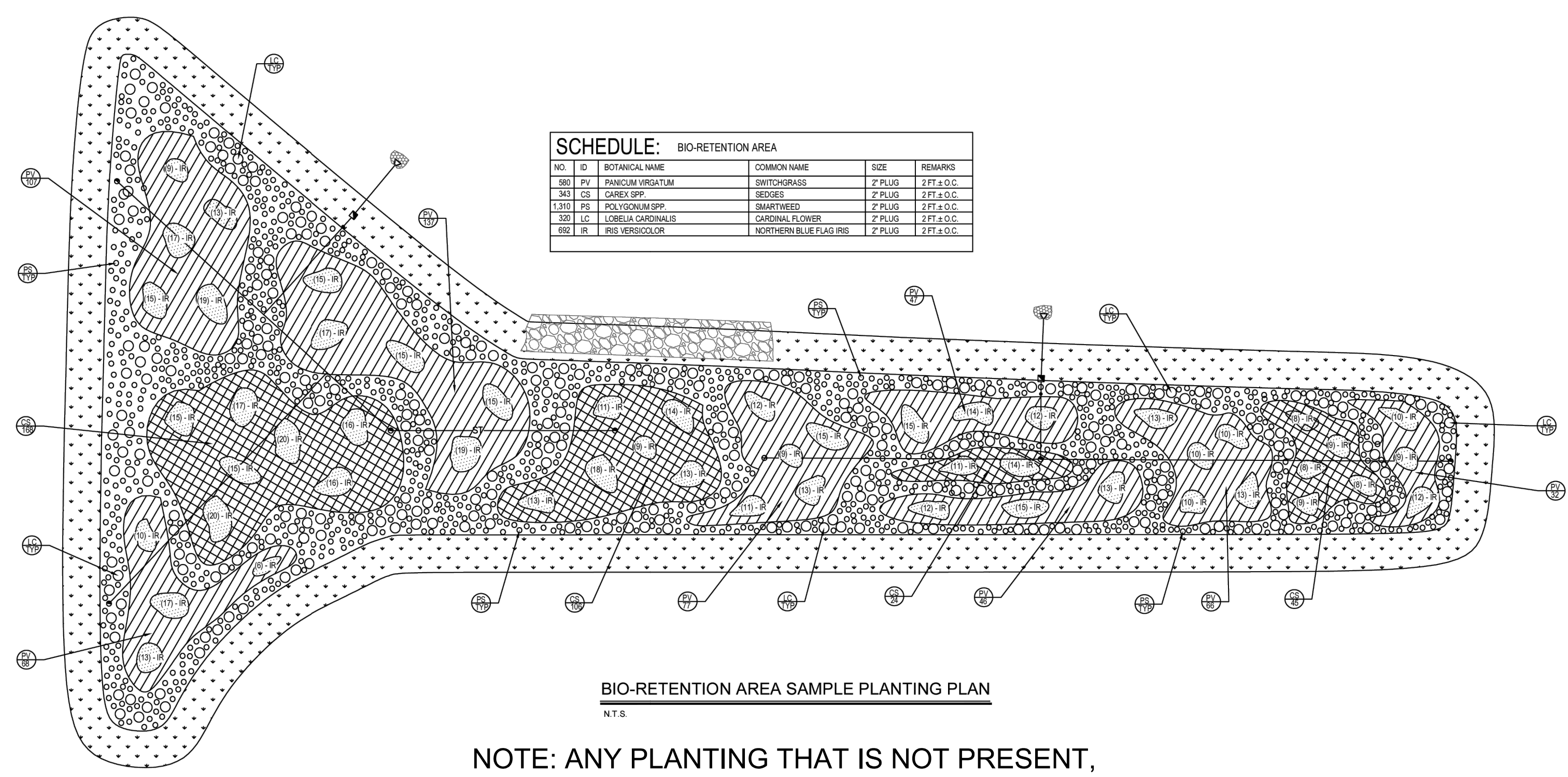



V:\081591 - Stream, NY\081591-01-001 (ENR) - Buffalo, Alabama, NY\Engineering\Plant\Stream - Project - BUFFALO\Streams\081591-01-SP-LANDSCAPE.dwg D:\081591-01-001-001.dwg 04/08/2024 04:08:20PM macedonia LAYOUT15-1 LANDSCAPE PLAN SCHEDULE AND DETAILS  
 Date: 08/15/24 10:00 AM  
 User: macedonia  
 Plot Date: 08/15/24 10:00 AM  
 Plot User: macedonia



**SCHEDULE: BIO-RETENTION AREA**

NO.	ID	BOTANICAL NAME	COMMON NAME	SIZE	REMARKS
01	WC	THUJA OCCIDENTALIS	WHITE CEDAR	10-12 HT	2 PLANT
02	UU	JUNIPERUS CHINENSIS 'BLUE POINT'	BLUE POINT UPRIGHT JUNIPER	4' HT	2 FT. PLANT
03	BW	BUXUS 'GREEN MOUNTAIN'	GREEN MOUNTAIN GLOBE BOXWOOD	3 GAL.	2 FT. PLANT
04	GC	CHAMAECYPARIS FISIFERA 'GOLDEN MOP'	GOLD MOP CYPRESS	1 GAL.	2 FT. PLANT

**NOTE: ANY PLANTING THAT IS NOT PRESENT, TO BE INSTALLED IN ACCORDANCE WITH THE BIO-RETENTION SAMPLE PLANTING PLAN AND SCHEDULE.**

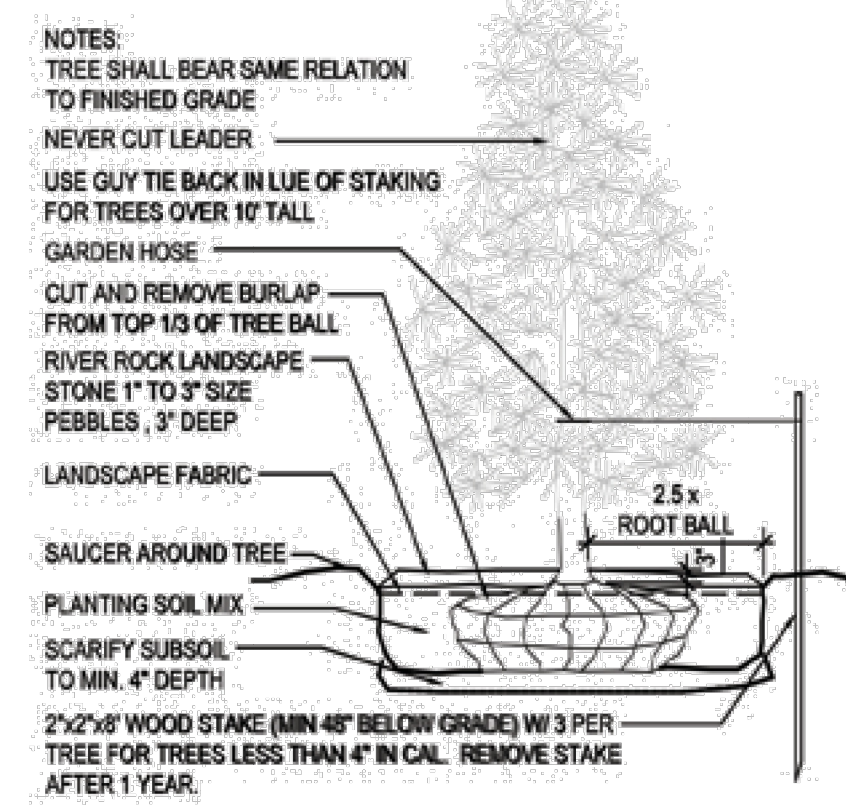

**PLANTING DETAILS**  
SCALE: NTS

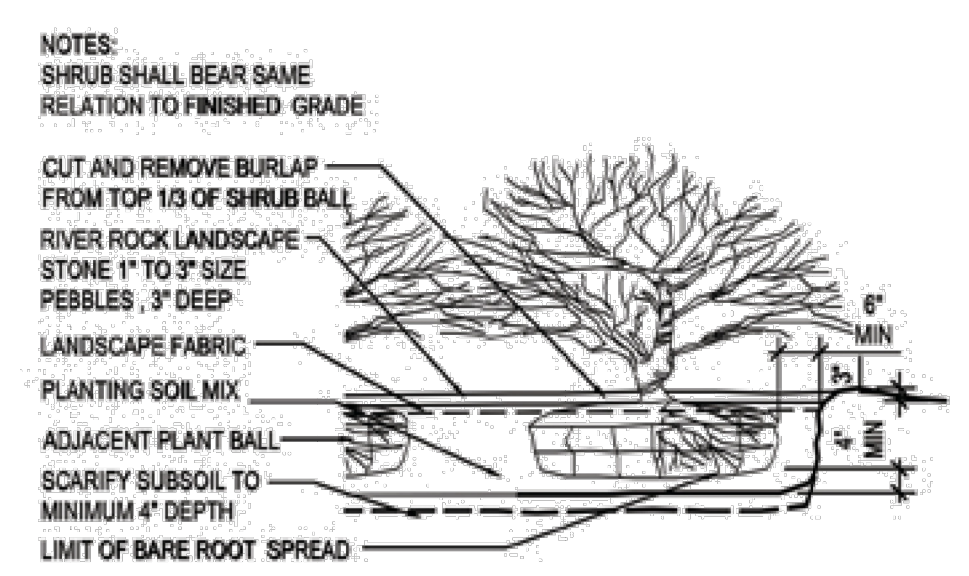

**NOTES:**  
SHRUBS SHALL BEAR SAME RELATION TO FINISHED GRADE

**PLANT SCHEDULE**

IMG	QTY	ID	BOTANICAL NAME	COMMON NAME	SIZE	ROOT	COMMENT
⊙	84	WC	THUJA OCCIDENTALIS	WHITE CEDAR	10-12 HT	BB	
⊕	13	UU	JUNIPERUS CHINENSIS 'BLUE POINT'	BLUE POINT UPRIGHT JUNIPER	4' HT	CONT.	
⊗	30	BW	BUXUS 'GREEN MOUNTAIN'	GREEN MOUNTAIN GLOBE BOXWOOD	3 GAL.	CONT.	
⊙	9	GC	CHAMAECYPARIS FISIFERA 'GOLDEN MOP'	GOLD MOP CYPRESS	1 GAL.	CONT.	

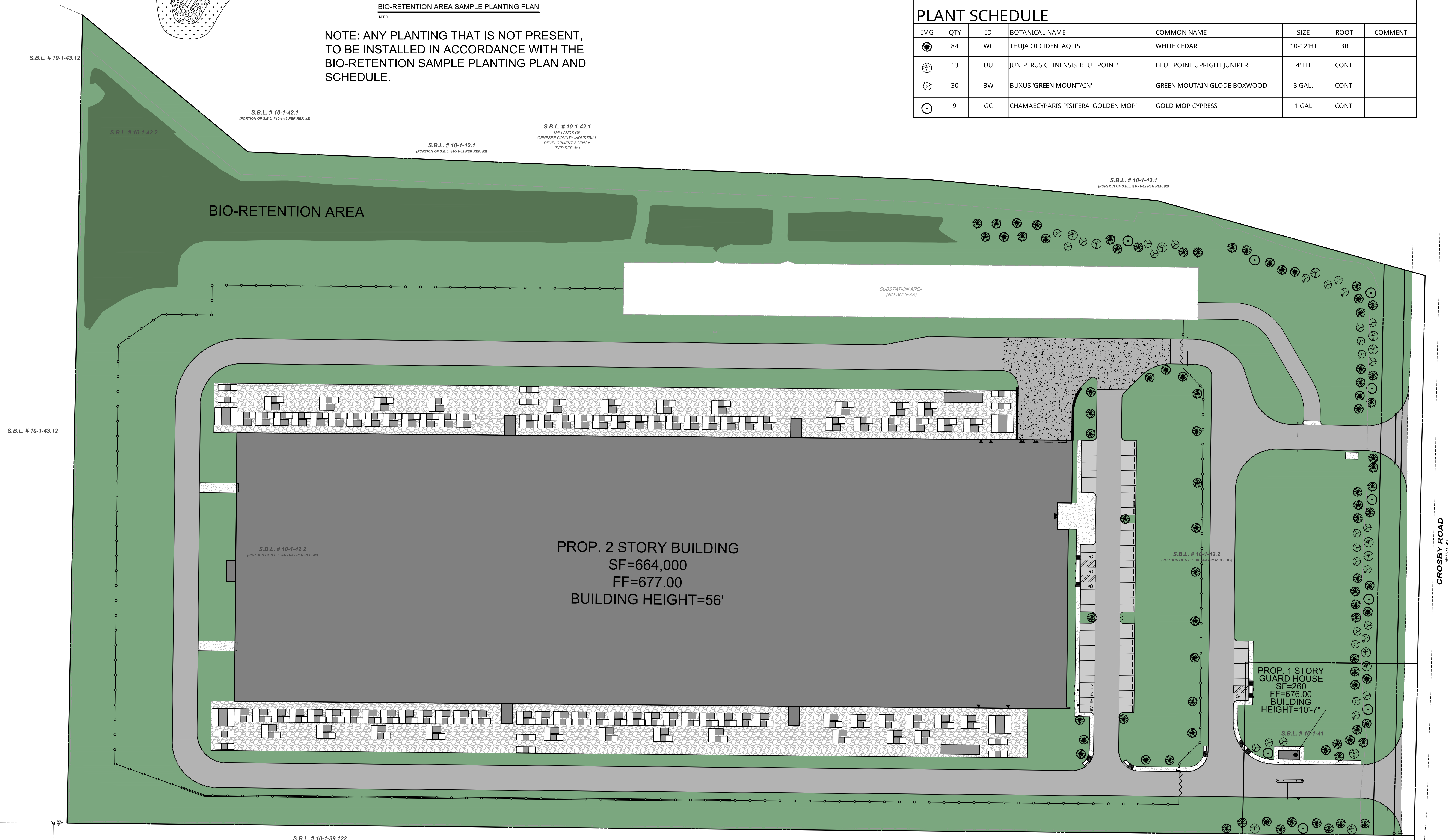

**PROP. 2 STORY BUILDING**  
SF=664,000  
FF=677.00  
BUILDING HEIGHT=56'

**PROP. 1 STORY GUARD HOUSE**  
SF=260  
FF=676.00  
BUILDING HEIGHT=10'-7"

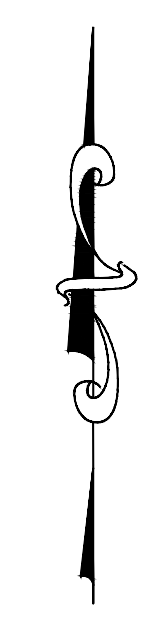
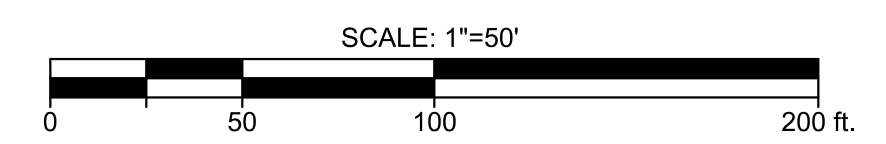

**BUFA - PROJECT DOUBLE REED SOUTH CAMPUS LANDSCAPE PLAN, SCHEDULE AND DETAILS**

TOWN OF ALABAMA, GENESEE COUNTY, NEW YORK

**Eric L. Keller**  
Professional Engineer, Lic. 085234-1

**Bowman**  
Bowman Consulting Engineering, Land Surveying & Landscape Architecture  
6 Campus Drive, Suite 302  
Pawling, New Jersey 07654  
Phone: 973.359.4400  
Fax: 973.359.4405  
E-mail: NJ@bowmaneng.com

**Eric L. Keller**  
Professional Engineer, Lic. 085234-1

**LS-1**