

III-f | PHOTOMETRIC PLAN

BUFA CAMPUS SITE LIGHTING NARRATIVE

New light fixtures and lighting controls compliant with New York Energy Code will be installed on both the north and south campus of the Stream BUFA campus. Light fixtures proposed to be installed on the campus are all proposed to be new LED fixtures inclusive of:

- Type S1 - 25ft tall LED pole lights with standard Type III distribution installed along roadways. International Dark Sky (IDA) Fixture Seal of Approval Available.
- Type FE - LED Wallpacks installed on building facade over loading dock doors.
- Type ST – LED yoke-mounted flood lights with wide throw distribution installed 25ft high on poles and aimed inwards towards substation transformers.

Based upon the proposed lighting plans, the BUFA campus is averaging 2fc along roadways, 3fc at loading docks, and 2.5fc at both the new and existing substations. No illuminance is found along most of the Stream campus property line with roadway entrances/exits experiencing up to 0.6fc from new roadway lighting at the property line.

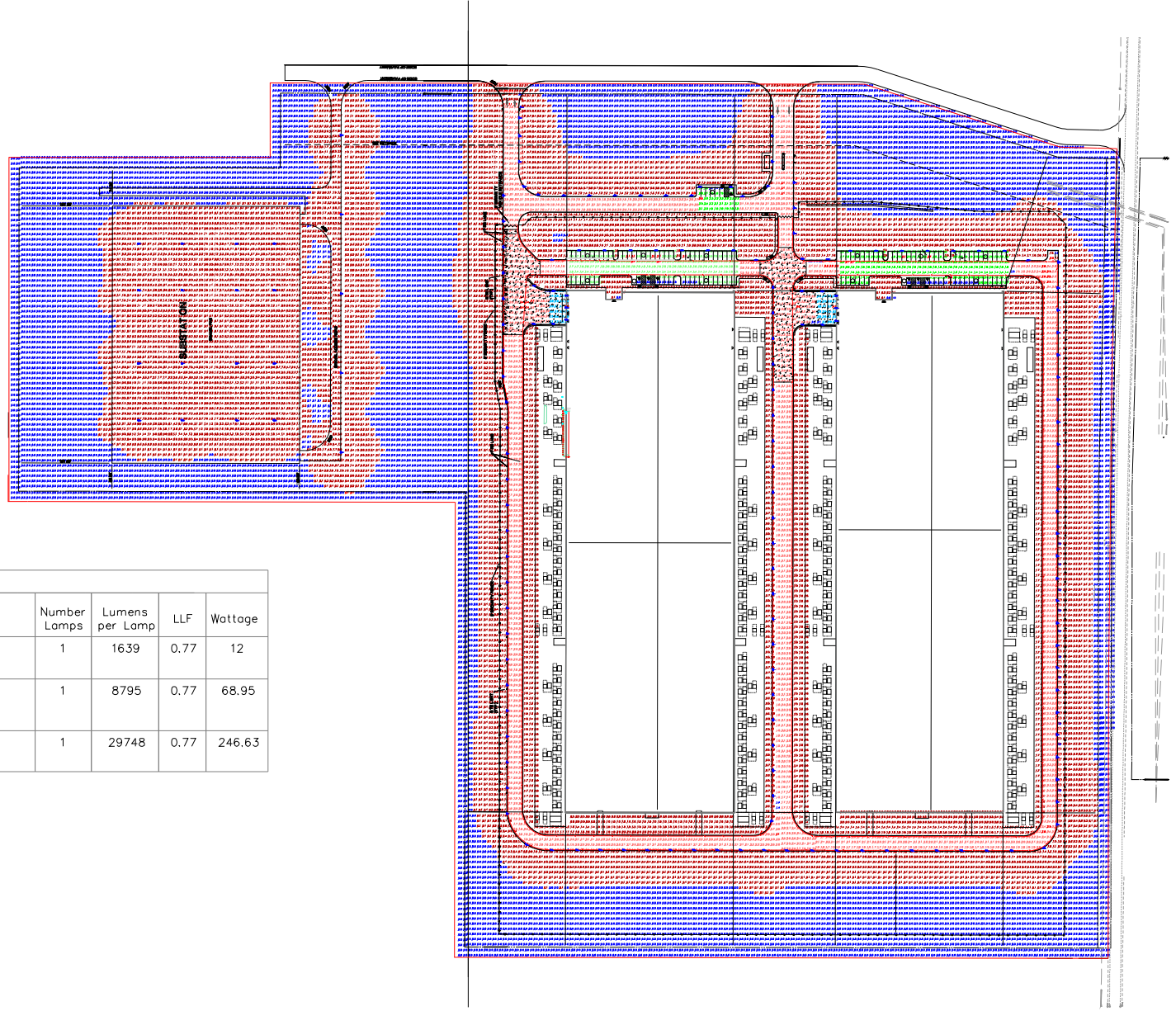

Statistics						
Description	Symbol	Avg	Max	Min	Max/Min	Avg/Min
Loading Dock Stats	+	3.2 fc	5.8 fc	2.0 fc	2.9:1	1.6:1
Roadway Stats	+	2.0 fc	3.7 fc	0.5 fc	7.4:1	4.0:1
Substation – Stats	+	1.9 fc	9.0 fc	0.0 fc	N/A	N/A

Schedule										
Symbol	Label	Manufactory	QTY	Catalog Number	Description	Lamp	Number Lamps	Lumens per Lamp	LLF	Wattage
□	FE	LITHONIA	6	WST LED P1 40K VF MVOLT	WST LED, Performance package 1, 4000 K, visual comfort forward throw, MVOLT	LED	1	1639	0.77	12
□	S1	LITHONIA	143	DSXO LED P3 40K 70CRI T3M	D-Series Size 0 Area Luminaire P3 Performance Package 4000K CCT 70 CRI Type 3 Medium	LED	1	8795	0.77	68.95
□	ST	LITHONIA	21	RSXF2 LED P6 40K WFL	RSXF Flood Fixture Size 2 P6 Lumen Package 4000K CCT Type WFL Distribution	LED	1	29748	0.77	246.63

NORTH CAMPUS

C:\Users\Labujawdeh\AppData\Local\Microsoft\Windows\NetCache\Content.Outlook\YCGSDMXC\01.27.2026 - BUFA - Photometrics - DIB LA.dwg Saved: 1/28/2026 9:37 AM

BUFA CAMPUS SITE LIGHTING NARRATIVE

New light fixtures and lighting controls compliant with New York Energy Code will be installed on both the north and south campus of the Stream BUFA campus. Light fixtures proposed to be installed on the campus are all proposed to be new LED fixtures inclusive of:

- Type S1 - 25ft tall LED pole lights with standard Type III distribution installed along roadways. International Dark Sky (IDA) Fixture Seal of Approval Available.
- Type FE - LED Wallpacks installed on building facade over loading dock doors.
- Type ST – LED yoke-mounted flood lights with wide throw distribution installed 25ft high on poles and aimed inwards towards substation transformers.

Based upon the proposed lighting plans, the BUFA campus is averaging 2fc along roadways, 3fc at loading docks, and 2.5fc at both the new and existing substations. No illuminance is found along most of the Stream campus property line with roadway entrances/exits experiencing up to 0.6fc from new roadway lighting at the property line.

Statistics						
Description	Symbol	Avg	Max	Min	Max/Min	Avg/Min
Loading Dock Stats	+	2.9 fc	5.0 fc	2.0 fc	2.5:1	1.5:1
Roadway Stats	+	2.1 fc	4.2 fc	0.6 fc	7.0:1	3.5:1
Substation – Stats	+	3.7 fc	14.1 fc	0.1 fc	141.0:1	37.0:1

Schedule										
Symbol	Label	Manufactory	QTY	Catalog Number	Description	Lamp	Number Lamps	Lumens per Lamp	LLF	Wattage
□	FE	LITHONIA	6	WST LED P1 40K VF MVOLT	WST LED, Performance package 1, 4000 K, visual comfort forward throw, MVOLT	LED	1	1639	0.77	12
□	S1	LITHONIA	93	DSX0 LED P3 40K 70CRI T3M	D-Series Size 0 Area Luminaire P3 Performance Package 4000K CCT 70 CRI Type 3 Medium	LED	1	8795	0.77	68.95
□	ST	LITHONIA	12	RSXF2 LED P6 40K WFL	RSXF Flood Fixture Size 2 P6 Lumen Package 4000K CCT Type WFL Distribution	LED	1	29748	0.77	246.63

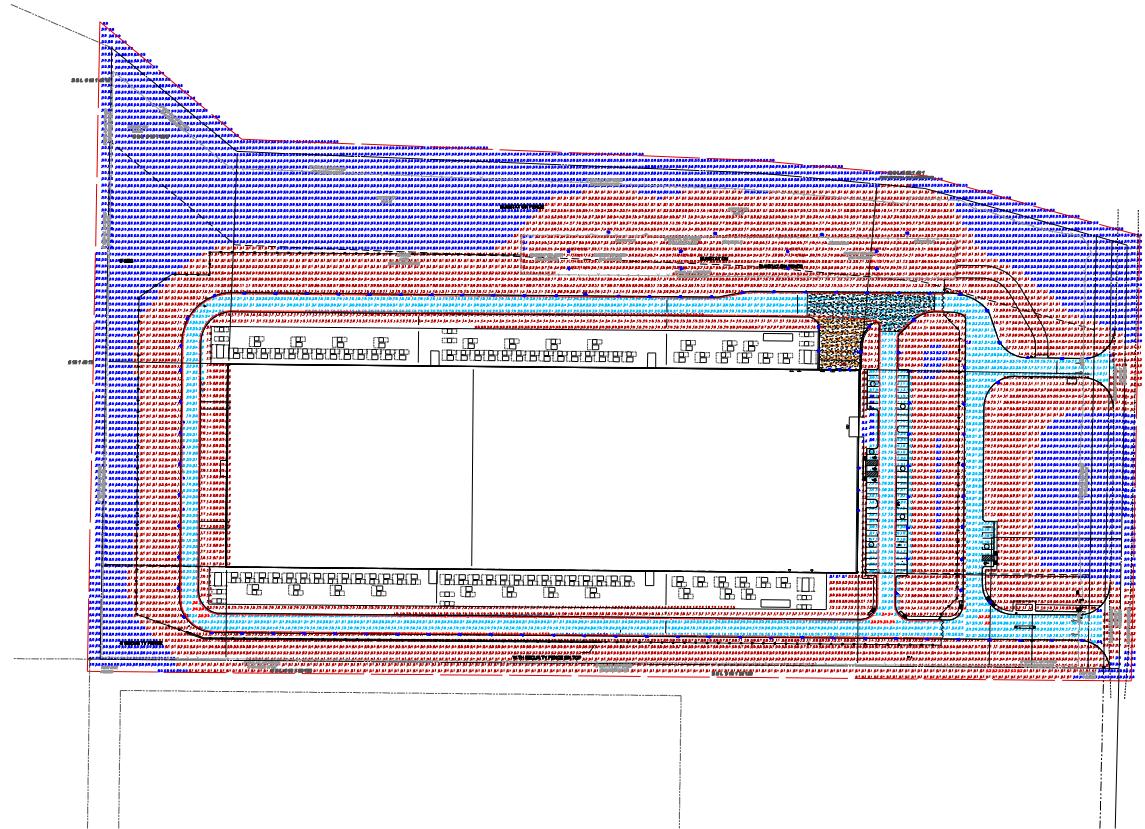

SOUTH CAMPUS